

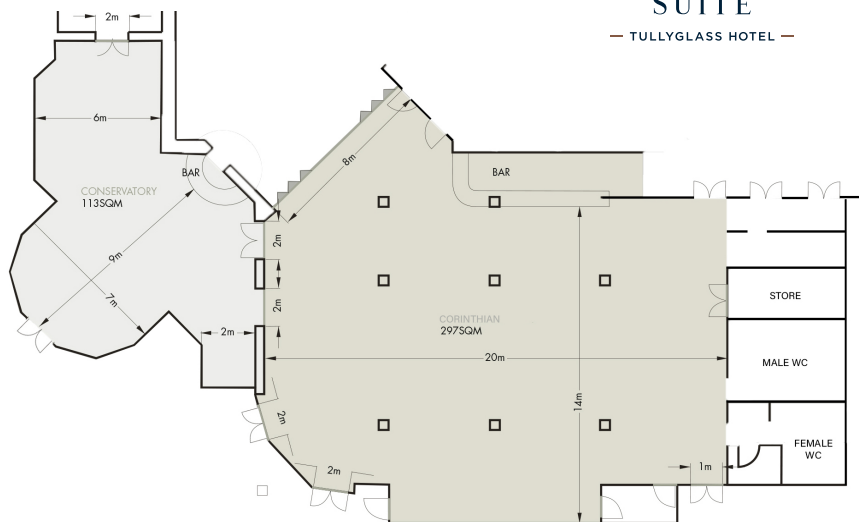

CORINTHIAN SUITE

— TULLYGLASS HOTEL —



Room Name		Corinthian Suite
Dimensions	Total Area	297m ²
	Room Size	20m x 14m
	Room Height	3m
	Entrance Width	1.75m
Capacities for...		
Room Setup Styles	Theatre	200
	Round Tables	200
	Cabaret	160
	Boardroom	50
	U/Shape	50
	Classroom	30

ROOM FEATURES

Our Corinthian Suite has just been restyled drawing its references from the Corinthian columns that featured in the original building. The Suite can cater for up to 200 guests or delegates 'theatre style' or round tables, 160 in 'cabaret style', or 50 'boardroom style'.

It also has the advantage of its location beside our Conservatory Suite which can for example, be used as breakout room, a pre-meeting space for coffee and canapes or other refreshments as delegates gather, or simply a registration space prior to an event.

- Adaptable space dependent upon your event
- Air Conditioning
- Fully Wheelchair Accessible
- Built-in / portable Staging
- Free super-fast W-IFI, offering up to 100mbps
- Built-in overhead data projector and screen (HDMI and VGA compatible)
- Integrated 'Martin audio PA System'
- Hearing Loop System
- Bespoke Equipment & Stationery Packs are available on request

Faultless service and venue"

I recently attended a business seminar in this fabulous hotel.

Conference room was the perfect setup providing a comfortable setting for the all-day event, all food received was of the highest standard with a faultless service and friendliness from all staff.